

DOMESTIC GARBAGE DISPOSER MIO Z 104

The garbage disposer Model MIO Z 104 is conceived for domestic purposes: essential at home, but useful also for caravans, canteens, health centres and many other places.

It is easy to use: just turn on cold water and switch on the disposer. Inserting all food leftovers in the hole of the sink, MIO Z 104 will rapidly and entirely erase them, grinding them in micrometric fragments, that will be drained easily through the generic sewage pipe.

What does it dispose of?

MIO Z 104 allows the disposal of all the organic waste of kitchens: chicken and steak bones, fish bones and shells, every kind of peel, vegetables, fruits, leaves of vegetables, fruit stones, nut and egg shells, glass, etc.

It does not dispose of:

Metal works (cans, cutlery, etc.), rubber, elastic fibres (rags, ropes, plastic bags, etc.).

The installation is simple: the only essential condition is the possibility to insert a rammer of 2" or 3" in the sink. The disposer MIO Z 104 may be easily installed on metal or ceramic sinks made up by one or two basins.

DESCRIPTION

Technical data:

- Crusher set of 0.5 HP standard;
- Single-phase motor 220V. – 50 HZ. 0,5 HP;
- Crusher components in alloy and high standard of carbon and nickelchrome;
- Revolutions per minute: 1450;
- Current: 3,5 A.;
- Switch controls with heat protection.

Equipped with:

- Rammer of 2" or 3" for stainless steel sinks or of 2" for ceramic sinks;
- Special siphon in moplen with connector for the exhaust pipe of the dishwasher;

Colour: ochre (mass-produced).

Size:

- Diameter: 185 mm;
- Height: 370 mm.

Different Voltage available by request.



GARBAGE DISPOSAL AIR SWITCH

EQUIPPED WITH:

- AIR SWITCH
- AIR PIPE
- ELECTRICAL PLANT FOR DEVICES UP TO 0,5 HP 220 V.

GARBAGE DISPOSAL

AIR SWITCH

AIR PIPE

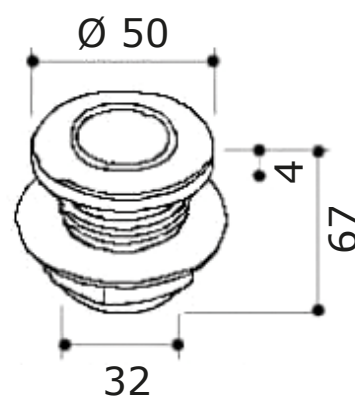

SINGLE OR DOUBLE-WAY SIPHON

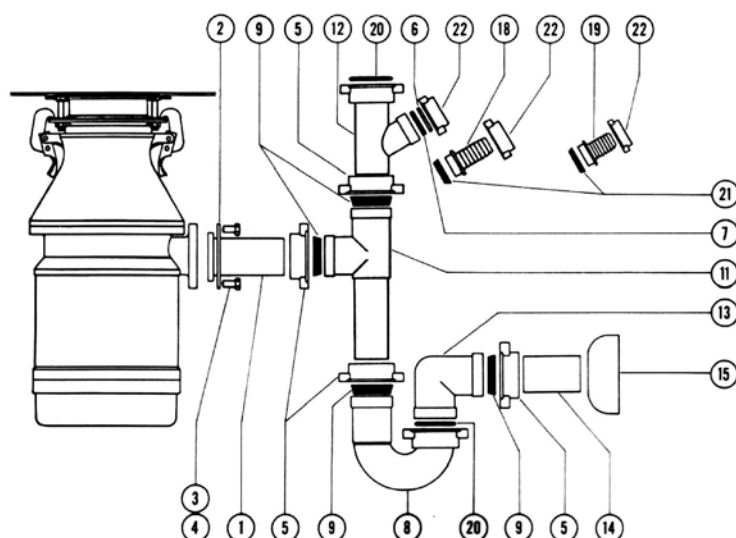
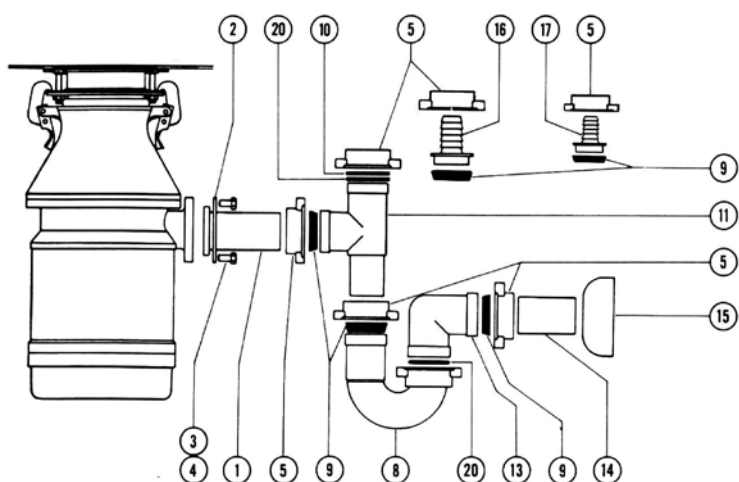

PLUGHOLE SET OF 2" FOR STAINLESS-STEEL AND CERAMIC SINKS

PLUGHOLE SET OF 3" FOR STAINLESS-STEEL SINKS

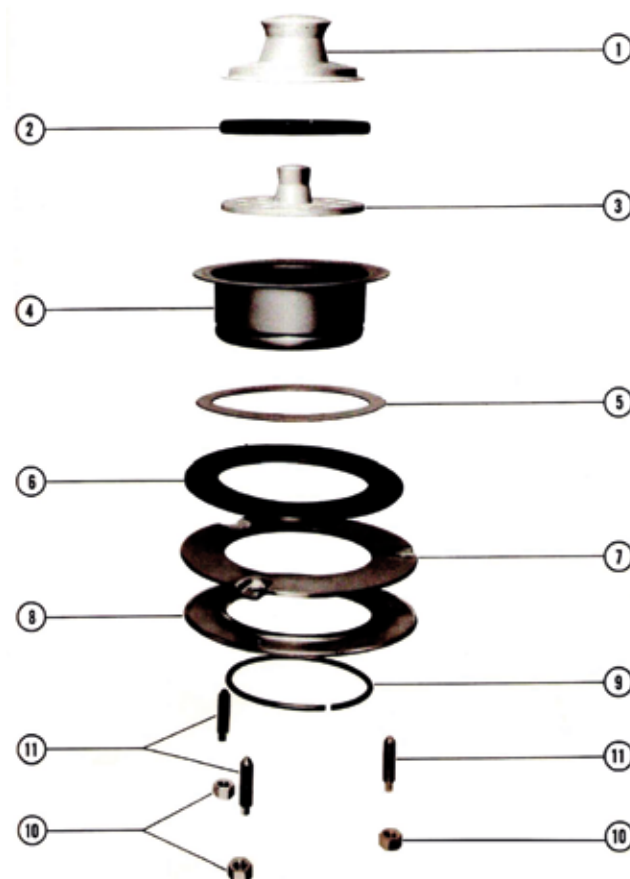
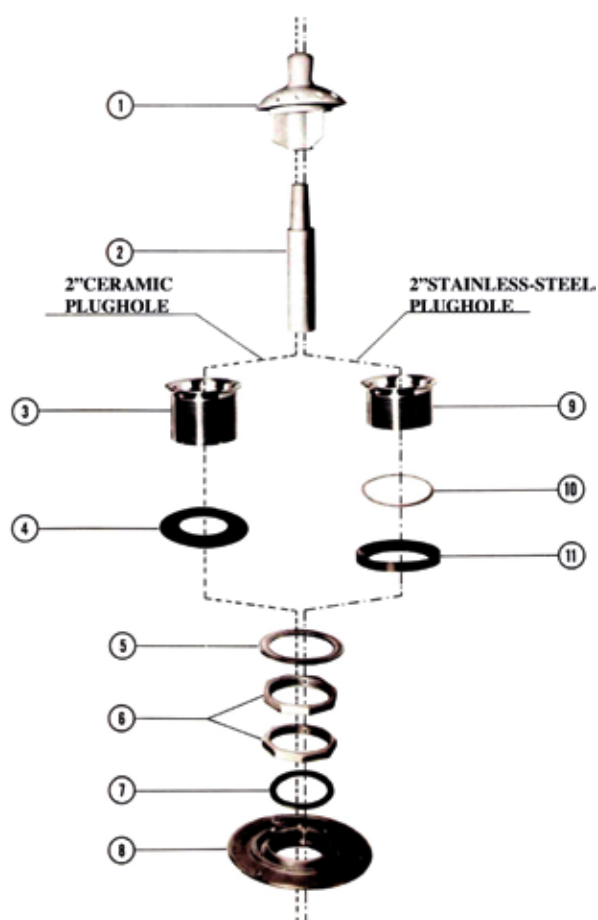

DOMESTIC GARBAGE DISPOSER Z 105

The garbage disposer Model Z 105 is conceived for domestic purposes: essential at home, but useful also for caravans, canteens, health centres and many other places.

It is easy to use: just turn on cold water and switch on the disposer. Inserting all food leftovers in the hole of the sink, Z 105 will rapidly and entirely erase them, grinding them in micrometric fragments, that will be drained easily through the generic sewage pipe.

What does it dispose of?

Z 105 allows the disposal of all the organic waste of kitchens: chicken and steak bones, fish bones and shells, every kind of peel, vegetables, fruits, leaves of vegetables, fruit stones, nut and egg shells, glass, etc.

It does not dispose of:

Metal works (cans, cutlery, etc.), rubber, elastic fibres (rags, ropes, plastic bags, etc.).

The installation is simple: the only essential condition is the possibility to insert a rammer of 2" or 3" in the sink. The disposer Z 105 may be easily installed on metal or ceramic sinks made up by one or two basins.

DESCRIPTION

Technical data:

- Crusher set of 1/2 HP;
- Single-phase motor 220V. – 50 HZ. 1/2 HP;
- Crusher components in alloy and high standard of carbon and nickelchrome;
- Revolutions per minute: 1450;
- Current: 3,5 A.;
- Motor protector;
- Exhaust diameter: 40 mm;
- Net weight: 15 kg.

Equipped with:

- Rammer of 2" or 3" for stainless steel sinks or of 2" for ceramic sinks;
- Special siphon in mopen with connector for the exhaust pipe of the dishwasher;
- Service key for the manual unblocking;
- Electric plant with converter;
- Locking and unlocking levers;
- Warranty of 36 months.

Colour: Royal blue (mass-produced).

Available in other colours by request (with extra charge).

Size:

- A: 170 mm;
- B: 190 mm;
- C: 360 mm;
- D: 92,5 mm;
- E: 89 mm.

Different Voltage available by request



DOMESTIC GARBAGE DISPOSER WITH PUMP EFFECT Z 105/P

The garbage disposer Model Z 105/P is conceived for domestic purposes: essential at home, but useful also for caravans, canteens, health centres and many other places. Thanks to its pump effect, this disposer is also ideal for basements, motor and sailing boats and wherever is needed a stronger thrust for the disposal of the crushed waste. It is easy to use: just turn on cold water and switch on the disposer. Inserting all food leftovers in the hole of the sink, Z 105/P will rapidly and entirely erase them, grinding them in micrometric fragments, that will be drained easily through the generic sewage pipe.

What does it dispose of?

Z 105/P allows the disposal of all the organic waste of kitchens: chicken and steak bones, fish bones and shells, every kind of peel, vegetables, fruits, leaves of vegetables, fruit stones, nut and egg shells, glass, etc.

It does not dispose of:

Metal works (cans, cutlery, etc.), rubber, elastic fibres (rags, ropes, plastic bags, etc.).

The installation is simple: the only essential condition is the possibility to insert a rammer of 2" or 3" in the sink. The disposer Z 105/P may be easily installed on metal or ceramic sinks made up by one or two basins.

DESCRIPTION

Technical data:

- Crusher set with pump effect of 1/2 HP;
- Single-phase motor 220V. – 50 HZ. 1/2 HP;
- Crusher components in alloy and high standard of carbon and nickelchrome;
- Revolutions per minute: 1450;
- Current: 3,5 A.;
- Motor protector;
- Exhaust diameter: 40 mm;
- Net weight: 15 kg.
- Discharge head: 2,5 mt H₂O

Equipped with:

- Rammer of 2" or 3" for stainless steel sinks or of 2" for ceramic sinks;
- Special siphon in moplen with connector for the exhaust pipe of the dishwasher;
- Service key for the manual unblocking;
- Electric plant with converter;
- Locking and unlocking levers;
- Warranty of 36 months.

Colour: Royal blue (mass-produced)

Available in other colours by request (with extra charge).

Size:

- A: 170 mm;
- B: 190 mm;
- C: 360 mm;
- D: 92,5 mm;
- E: 89 mm.

Different Voltage available by request



DISPOSER FOR SMALL COMMUNITIES Z 106

The garbage disposer Model Z 106 is conceived for community purposes like: fish markets, fruit and vegetable markets, canteens, restaurants and especially small and medium-sized boats. The disposer Z 106 guarantees perfect results also in extreme conditions, and can be provided or not with a stainless-steel container.

Z 106 allows, by breaking up the materials into micrometric parts, the disposal of: chicken and steak bones, fish bones and shells, vegetables, fruits, every kind of peel, leaves of vegetables, fruit stones, nut and egg shells, biodegradable paper, glass, etc. This disposer crushes the wastes avoiding their stagnation and putrefaction.

The installation is simple: the only essential condition is the possibility to insert a rammer of 2" or 3" (supplied with the disposer) in the sink. The disposer Z 106 may be easily installed on metal or ceramic sinks made up by one or two basins.

DESCRIPTION

Technical data:

- Crusher set 1.5 HP;
- Three-phase motor 220-380 V. – 50 HZ. 1.5 HP;
- Crusher components in alloy and high standard of carbon and nickelchrome;
- Revolutions per minute: 1400 (2800 optional);
- Starting Current: 7 A. with EC standards;
- Motor protector;
- Exhaust diameter: 40 mm;
- Disposal capacity: 50-70 kg/h.
- Net weight: 16 Kg.

Equipped with:

- Rammer of 2" or 3" for stainless steel sinks or of 2" for ceramic sinks;
- Special siphon in moplen with connector for the exhaust pipe of the dishwasher;
- Service key for the manual unblocking;
- Electric plant with converter;
- Locking and unlocking levers;

Colour: Royal blue (mass-produced).

Size:

- A: 170 mm;
- B: 190 mm;
- C: 445 mm;
- D: 92,5 mm;
- E: 89 mm.

Different Voltage available by request.



DISPOSER FOR SMALL COMMUNITIES WITH PUMP EFFECT Z 106/P

The garbage disposer Model Z 106/P is conceived for community purposes like: fish markets, fruit and vegetable markets, canteens, restaurants small and medium-sized boats and wherever is needed a stronger thrust for the disposal of the crushed waste.

The disposer Z 106/P guarantees perfect results also in extreme conditions, and can be provided or not with a stainless-steel container.

Z 106 allows, by breaking up the materials into micrometric parts, the disposal of: chicken and steak bones, fish bones and shells, vegetables, fruits, every kind of peel, leaves of vegetables, fruit stones, nut and egg shells, biodegradable paper, glass, etc. This disposer crushes the wastes avoiding their stagnation and putrefaction.

The installation is simple: the only essential condition is the possibility to insert a rammer of 2" or 3" (supplied with the disposer) in the sink. The disposer Z 106 may be easily installed on metal or ceramic sinks made up by one or two basins.

DESCRIPTION

Technical data:

- Crusher set with pump effect 1.5 HP;
- Three-phase motor 220-380 V. – 50 HZ. 1.5 HP;
- Crusher components in alloy and high standard of carbon and nickelchrome;
- Revolutions per minute: 1400;
- Starting Current: 7 A. with EC standards;
- Motor protector;
- Exhaust diameter: 40 mm;
- Disposal capacity: 50-70 kg/h.
- Net weight: 17 kg.
- Discharge head 2.5 mt H₂O

Equipped with:

- Rammer of 2" or 3" for stainless steel sinks or of 2" for ceramic sinks;
- Special siphon in moplen with connector for the exhaust pipe of the dishwasher;
- Service key for the manual unblocking;
- Electric plant with converter;
- Locking and unlocking levers;

Colour: Royal blue (mass-produced).

Size:

- A: 170 mm;
- B: 190 mm;
- C: 445 mm;
- D: 92,5 mm;
- E: 89 mm.

Different Voltage available by request.



DISPOSER FOR SMALL COMMUNITIES Z 106 INOX

The garbage disposer Model Z 106 INOX is conceived for community purposes like: fish markets, fruit and vegetable markets, canteens, restaurants and especially small-sized boats. The disposer Z 106 INOX guarantees perfect results also in extreme conditions, and is provided in a stainless-steel container and is equipped with a conical basin with a waste-hole entrance of 90 Ø mm.

Z 106 INOX allows, by breaking up the materials into micrometric parts, the disposal of: chicken and steak bones, fish bones and shells, vegetables, fruits, every kind of peel, leaves of vegetables, fruit stones, nut and egg shells, biodegradable paper, glass, etc. This disposer crushes the wastes avoiding their stagnation and putrefaction.

DESCRIPTION

Technical data:

- Crusher set 1.5 HP;
- Three-phase motor 220-380 V. – 50 HZ. 1.5 HP with heat protection;
- Crusher components in alloy and high standard of carbon and nickelchrome;
- Revolutions per minute: 2800;
- Starting Current: 7 A. with EC standards;
- Ancillary controls 24V for reverse with heat protection;
- Switch buttons (reverse, stop, forward);
- Low voltage switchboard;
- Exhaust diameter: 40 mm;
- Hydraulic system that starts with water input;
- Disposal capacity: 50-70 kg/h.

Equipped with:

- Stainless-steel container A.1.S.1.304 with round basin;
- Stainless-steel structural frame A.1.S.1.304 to fit the disposer set;
- Flexible metal hose of 120 cm of ¾" (for the link with the water channel)
- Special siphon in mopen;
- Service key for the manual unblocking;

Size:

- Height: 850 mm;
- Width: 440 mm;
- Depth: 560 mm;
- Weight: 45 kg.;

- Different Voltage available by request.
- Configuration with crushing set with pump effect available by request.



DISPOSER FOR SMALL COMMUNITIES Z 106 INOX SPECIAL

The garbage disposer Model Z 106 INOX SPECIAL is conceived for community purposes like: fish markets, fruit and vegetable markets, canteens, restaurants and especially small-sized boats. The disposer Z 106 INOX SPECIAL guarantees perfect results also in extreme conditions, and is provided in a stainless-steel container equipped with a rectangular basin provided of a safety system inside the hopper.

Z 106 INOX SPECIAL allows, by breaking up the materials into micrometric parts, the disposal of: chicken and steak bones, fish bones and shells, vegetables, fruits, every kind of peel, leaves of vegetables, fruit stones, nut and egg shells, biodegradable paper, glass, etc. This disposer crushes the wastes avoiding their stagnation and putrefaction.

DESCRIPTION

Technical data:

- Crusher set 1.5 HP;
- Three-phase motor 220-380 V. – 50 HZ. 1.5 HP with heat protection;
- Crusher components in alloy and high standard of carbon and nickelchrome;
- Revolutions per minute: 2800;
- Starting Current: 7 A. with EC standards;
- Ancillary controls 24V for reverse with heat protection;
- Switch buttons (reverse, stop, forward);
- Low voltage switchboard;
- Exhaust diameter: 40 mm;
- Hydraulic system that starts with water input;
- Disposal capacity: 50-70 kg/h.

Equipped with:

- Stainless-steel container A.1.S.1.304;
- Stainless-steel structural frame A.1.S.1.304 to fit the disposer set;
- Safety System inside the hopper for the prevention of accidents;
- Flexible metal hose of 120 cm of $\frac{3}{4}$ " (for the link with the water channel)
- Special siphon in mopen;
- Service key for the manual unblocking;

Size:

- Height: 850 mm;
- Width: 400 mm;
- Depth: 700 mm;
- Weight: 55 kg.;

Different Voltage available by request.



DISPOSER FOR COMMUNITIES T 300

The garbage disposer Model T 300 is conceived for community purposes like: fish markets, fruit and vegetable markets, canteens and restaurants. The disposer T 300 is provided in a stainless-steel container and is equipped with a rectangular basin provided of a safety system inside the hopper.

Even though the T 300 is one of the most economic machines of its category, owns characteristics that make of it a proper 'mill' for food waste. It crushes through specially treated steel hammers and is equipped with a double ring system that makes the activity totally watertight and keeps safe the space around the motor. Its rigid and compact structure guarantees an efficient employment of long duration.

DESCRIPTION

Technical data:

- Crusher set 3 HP;
- Three-phase motor 220-380 V. – 50 HZ. 3 HP with heat protection;
- Crusher components in alloy and high standard of carbon and nickelchrome;
- Starting Current: with EC 6-4 A standards;
- Ancillary controls 24V for reverse with heat protection;
- Switch buttons (reverse, stop, forward);
- Low voltage switchboard;
- Exhaust diameter: 60 mm;
- Hydraulic system that starts with water input;
- Disposal capacity: 100-150 kg/h.

Equipped with:

- Stainless-steel container A.1.S.1.304;
- Stainless-steel structural frame A.1.S.1.304 to fit the disposer set;
- Safety System inside the hopper for the prevention of accidents;
- Flexible metal hose of 120 cm of $\frac{3}{4}$ " (for the link with the water channel)

Size:

- Height: 850 mm;
- Width: 400 mm;
- Depth: 700 mm;
- Weight: 120 kg.

Different Voltage available by request.



DISPOSER FOR COMMUNITIES: T 421

Garbage disposer with simple milling process

The garbage disposer Model T 421 is conceived for community purposes like: fish markets, fruit and vegetable markets, canteens and restaurants.

This model works through a simple milling process with 'pump effect': it crushes the waste and then expels the wastewater like a centrifugal pump. T 421 crushes through specially treated steel hammers and is equipped with a double ring system that makes the activity totally watertight and keeps safe the space around the motor. Its rigid and compact structure guarantees an efficient employment of long duration.

DESCRIPTION

Technical data:

- Crusher set 4 HP;
- Three-phase motor 220-380 V. – 50 HZ. 4 HP;
- Crusher components in alloy and high standard of carbon and nickelchrome;
- Starting Current: with EC standards 10-6 A;
- Low voltage external controls 24V (optional);
- Waste input opening: 110 mm;
- Discharge capacity: 1mc/h a H=1,5 mt;
- Disposal capacity: 220-250 kg/h.
- Electric plant with switch buttons, reverse controls (reverse, stop, forward), and heat protection;
- Exhaust diameter: 3" internally threaded 1" ½", externally threaded 2";

Equipped with:

- Three-legged support (without container and without hydraulic channel).

Size:

- Height: 632 mm;
- Diameter: 327 mm;
- Weight: 90 kg.

Different Voltage available by request.



DISPOSER FOR COMMUNITIES: T 402

Garbage disposer with simple milling process

The garbage disposer Model T 402 is conceived for community purposes like: fish markets, fruit and vegetable markets, canteens and restaurants. This model works through a simple milling process belt-based with 'pump effect': it crushes the waste and then expels the wastewater like a centrifugal pump.

T 402 crushes through specially treated steel hammers and is equipped with a double ring system that makes the activity totally watertight and keeps safe the space around the motor. Its rigid and compact structure guarantees an efficient employment of long duration.

DESCRIPTION

Technical data:

- Crusher set 4 HP with transmission belts;
- Three-phase motor 220-380 V. – 50 HZ. 4 HP;
- Crusher components in alloy and high standard of carbon and nickelchrome;
- Starting Current: with EC standards 6-4 A;
- Low voltage external controls 24V;
- Hydraulic circuit starting with water input;
- Disposal capacity: 220-250 kg/h.
- Switch buttons (reverse, stop, forward) with heat protection;
- Exhaust diameter: 3", internally threaded

Equipped with:

- Carinate in stainless-steel A.1.S.1.304;
- Stainless-steel structural frame A.1.S.1.304 to fit the disposer set;
- Basin with Safety System for the prevention of accidents;
- Flexible metal hose of 120 cm of 3/4" (for the link with the water channel)

Size:

- Height: 850 mm;
- Width: 400 mm;
- Depth: 700 mm;
- Weight: 130 kg.

Different Voltage available by request.



DISPOSER FOR COMMUNITIES: T 402 MT

Garbage disposer with simple milling process

The garbage disposer Model T 402 MT is conceived for community purposes like: fish markets, fruit and vegetable markets, canteens and restaurants. This model works through a simple milling process belt-based with 'pump effect': it crushes the waste and then expels the wastewater like a centrifugal pump. Even though the T 402 MT is one of the most economic machines of its category, owns characteristics that make of it a proper 'mill' for food waste.

T 402 MT is placed in a stainless-steel container bigger than the one of the model T 402, and has a wider worktop. This disposer crushes through specially treated steel hammers and is equipped with a double ring system that makes the activity totally watertight and keeps safe the space around the motor. Its rigid and compact structure guarantees an efficient employment of long duration.

DESCRIPTION

Technical data:

- Crusher set 4 HP with transmission belts;
- Three-phase motor 220-380 V. – 50 HZ. 4 HP;
- Crusher components in alloy and high standard of carbon and nickelchrome;
- Starting Current: with EC standards 10-6 A;
- Low voltage external controls 24V (optional);
- Hydraulic circuit starting with water input;
- Switch buttons (reverse, stop, forward) with heat protection;
- Exhaust diameter: 3" internally threaded 1" ½", externally threaded 2";
- Disposal capacity: 220-250 kg/h.

Equipped with:

- Structure in stainless-steel A.1.S.1.304;
- Stainless-steel structural frame A.1.S.1.304 to fit the disposer set;
- Basin with Safety System for the prevention of accidents;
- Flexible metal hose of 120 cm of ¾" (for the link with the water channel)

Size:

- Height: 850 mm;
- Width: 700 mm;
- Depth: 700 mm;
- Weight: 140 kg.

Different Voltage available by request.



PRE-WASHING FOR DISHWASHERS: T 421 SPECIAL

Garbage disposer with simple milling process

The garbage disposer Model T 421 SPECIAL is conceived for large community purposes like: fish markets, fruit and vegetable markets, canteens, restaurants and especially in industrial dishwashing plants. This model works through a simple crushing process with 'pump effect': it crushes the waste and then expels the wastewater like a centrifugal pump.

T 421 SPECIAL is supplied within a stainless-steel container with an inclined top equipped with sliding tracks. T 421 SPECIAL needs to be installed before the plant of the industrial dishwashers. This disposer crushes through specially treated steel hammers, works as pre-washing system and is equipped with a double ring system that makes the activity totally watertight and keeps safe the space around the motor. Its rigid and compact structure guarantees an efficient employment of long duration.

DESCRIPTION

Technical data:

- Crusher set 4 HP;
- Three-phase motor 220-380 V. – 50 HZ. 4 HP;
- Crusher components in alloy and high standard of carbon and nickelchrome;
- Starting Current: with EC standards 10-6 A;
- Low voltage external controls 24V
- Switch buttons (reverse, stop, forward) with heat protection;
- Exhaust diameter: 3" internally threaded 1" ½", externally threaded 2";
- Discharge capacity: 1mc/h a H=1,5 mt;
- Pre-washing serve-controlled spray system at the start with guidelines;
- Disposal capacity: 220-250 kg/h;

Equipped with:

- Stainless-steel unit;
- Stainless-steel structural frame A.1.S.1.304 to fit the disposer set;
- Safety System inside the hopper for the prevention of accidents (continuous cycle);

Size:

- Height: 1800 mm;
- Height of worktop: 850 mm;
- Length: 2270 mm;
- Width: 775 mm;
- Depth: 700 mm;
- Weight: 110 kg.



WORKTABLE KOMBI 2000

With waste-crushing disposer

The Worktable KOMBI 2000 is a complete worktop equipped with a set of two disposer inside, that allow the disposal of meat, fish and vegetables. It owns a mixer faucet set of industrial shower type and a sink-basin with an upper washing grid.

The two disposers placed inside are:

- + Garbage disposer mod. T 300 with crusher set of 3.0 HP;
- + Garbage disposer mod Z 106 with crusher set of 1.5 HP
(installed in the plughole)

DESCRIPTION

Technical data:

- Total power of the crusher set 4,5 HP;
- Three-phase motor 220-380 V. – 50 HZ;
- Starting Current: with EC standards 10/8 A;
- Low voltage external controls 24V in a IP55 box;
- Electric watertight display IP55;
- Water consumption: 150 lt/h;
- Disposal capacity: 100-150 kg/h;
- Revolutions per minute: 1400;
- Diameter of input opening: $\frac{3}{4}$ "
- Switch buttons (reverse, stop, forward);
- Exhaust diameter: 60 mm (40 mm Z106);
- Safety System inside the hopper for the prevention of accidents (continuous cycle).

Equipped with:

- Worktop and basin in stainless-steel a.1.S.1.304.

Size:

- Height: 850 mm;
- Length: 1600 mm;
- Width: 750 mm;
- Depth: 700;
- Weight: 160 kg;
- Gross Weight with packaging: 180 kg.

Different Voltage available by request.



DISPOSER FOR COMMUNITIES: B 501

Double-milling process crushing-waste disposer

The garbage disposer Model B 501 is conceived for large community purposes like hotels, restaurants and hospitals.

B 501 crushes in two stages: firstly through a group of tempered-steel small pillars and hammers, and then there is the refining crushing.

B 501 owns an original mechanical configuration that differentiates it from all the other machinery available on the market, because the motor is linked with the rotating components of the disposer through a set of belts, forming a cushioning element that is very useful for situations in which too big or too hard objects are introduced in the structure.

DESCRIPTION

Technical data:

- Crusher set of 5,5 HP with transmission belts;
- Three-phase motor 220-380 V. – 50 HZ. 5,5 HP;
- Crusher components in alloy and high standard of carbon and nickelchrome;
- Starting Current: with EC standards 16-10 A;
- Hydraulic circuit starting with water input;
- Ancillary controls (24V) with Switch buttons (reverse, stop, forward) with heat protection;
- Exhaust diameter: 3"
- Disposal capacity: 300-400 kg/h.

Equipped with:

- Structure in stainless-steel A.1.S.1.304;
- Stainless-steel structural frame A.1.S.1.304 to fit the disposer set;
- Basin with Safety System for the prevention of accidents (continuous cycle);
- Flexible metal hose of 120 cm of ¾" (for the link with the water channel)

Size:

- Height: 850 mm;
- Width: 400 mm;
- Depth: 700 mm;
- Weight: 230 kg.

Different Voltage available by request.



DISPOSER FOR COMMUNITIES: B 701

Double-milling process crushing-waste disposer

The garbage disposer Model B 701 is conceived for large community purposes like hotels, restaurants and hospitals.

B 701 crushes in two stages: firstly through a group of tempered-steel small pillars and hammers, and then there is the refining crushing.

B 701 owns an original mechanical configuration that differentiates it from all the other machinery available on the market, because the motor is linked with the rotating components of the disposer through a set of belts, forming a cushioning element that is very useful for situations in which too big or too hard objects are introduced in the structure.

DESCRIPTION

Technical data:

- Crusher set of 7,5 HP with transmission belts;
- Three-phase motor 220-380 V. – 50 HZ. 7,5 HP;
- Crusher components in alloy and high standard of carbon and nickelchrome;
- Starting Current: with EC standards 21-12 A;
- Hydraulic circuit starting with water input;
- Ancillary controls (24V) with Switch buttons (reverse, stop, forward) with heat protection;
- Watertight display 1P 55
- Exhaust diameter: 3"
- Disposal capacity: 400-600 kg/h.

Equipped with:

- Structure in stainless-steel and nickelchrome;
- Iron structural frame to fit the disposer set;
- Flexible metal hose of 120 cm of $\frac{3}{4}$ " (for the link with the water channel)

Size:

- Height: 850 mm;
- Width: 700 mm;
- Depth: 700 mm;
- Weight: 330 kg.

Different Voltage available by request.













OPTIONAL ACCESSORIES

Besides the wide range of machinery proposed, VIDOTTO DISSIPATORI offers also a large number of accessories available by request, in order to improve the activities of the equipments and ease their use.

Automatic device intercepting cutlery and iron materials

This device is applicable to the following models:

-  Z 106 INOX SPECIAL
-  T 300
-  T 401
-  T 402
-  B 501
-  B701
-  T 421 SPECIAL
-  PULPER BIG 501
-  PULPER BIG 501 MILLENIUM
-  PULPER BIG 701
-  PULPER BIG 701 MILLENIUM

Available on other models by request.



Piletta Ø 240 – Rammer Ø 240

This Rammer group of Ø 240 is made of stainless-steel A.1.S.1. 304, equipped with a safety system and with hydraulic circuit adaptable to a disposal table in place of the plughole.

This device is applicable to the following models:

-  T 421
-  Z 106
-  T 300 (Without Structure)

Standard: D: 290 mm L: 270 mm

Available in other sizes by request.
Available a set of customizable basins and hoppers.

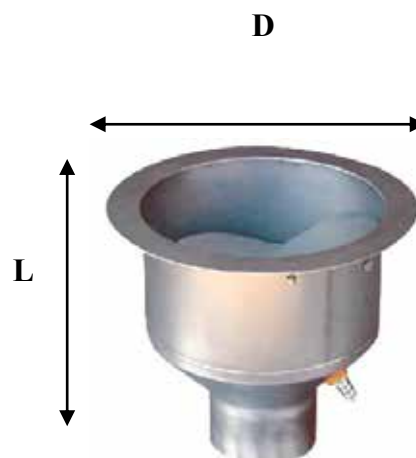

IN-LINE PUMP GRINDER FOR RAISING PLANTS: PUMP GRINDER TM 451

An obstructed sewer creates much more problems than a black-out.

VIDOTTO's all-round experience in civil and industrial crushing machines, brought to the setting up of a new type of grinder able to solve definitively the problem of the drainage system obstructions.

TM 451 will be placed at the most suitable point of the drain pipe and there will start grinding every kind of solid waste (i.e. rags, nylon, paper, paperboard, wood shavings, etc.). This grinder works exactly like a pump: it transports the crushed materials through the water directly to the main sewers. Furthermore, when someone owns sewers placed at a lower level than the main ones (i.e. half-buried or constructions on slopes), the use of TM 451 permits the removal of the generic pumps.

TM 451 allows besides, plant savings, because it can work also with small-diameter drainage pipes.

DESCRIPTION

Technical data:

- Crusher set of 5,5 HP in special alloy;
- Three-phase motor 220-380 V. – 50 HZ. 5,5 HP;
- Starting Current: with EC standards 16-10 A;
- Power: 4 Kw;
- Switch buttons (reverse, stop, forward) with heat protection;
- Watertight display 1P 55;
- Waste suction inlet diameter: 140 mm (coes pipe 110);
- External drain pipe diameter: 3" internally threaded 1" ½", externally threaded 2";
- Discharge head: 40 mc/h to H=6 mt

Equipped with:

- Three-legged support or L shaped clamp.

Size:

- Height: 755 mm;
- Weight: 100 kg.

Different Voltage available by request.



IMMERSION PUMP GRINDER FOR RAISING PLANTS: IMMERSION PUMP GRINDER TMS 451

VIDOTTO's all-round experience in civil and industrial crushing machines, brought to the setting up of a new type of grinder able to solve definitively the problem of raising waste water in collection tanks. TMS 451 will be immersed in the collection tank and will start grinding every kind of solid waste working like a pump, so, transporting the drained water directly to the main sewers without any obstruction.

Moreover, the use of TMS 451 permits the removal of the generic pumps, which, as everybody knows, tend to get obstructed easily.

TMS 451 allows besides, plant savings, because it can work also with small-diameter drainage pipes.

DESCRIPTION

Technical data:

- Crusher set of 5 HP in special alloy;
- Immersed flameproof Three-phase motor 220-380 V. – 50 HZ. 5 HP;
- Starting Current: with EC standards 16-10 A;
- Power: 4 Kw;
- Manual switch buttons (reverse, stop, forward) with heat protection;
- Watertight display 1P 55;
- Waste suction inlet diameter: 140 mm;
- External drain pipe diameter: 3" internally threaded 1" ½", externally threaded 2";
- Discharge head: 40 mc/h to H=6 mt

Equipped with:

- Three-legged support or L shaped clamp (depending on the necessity of application).

Size:

- Height: 755 mm;
- Width: 385 mm;
- Suction: 130 mm Ø;
- Weight: 100 kg.

Different Voltage available by request.



ORGANIC WASTE DISPOSER: TM AGRI

The organic waste disposer Model TM AGRI is conceived to grind every kind of organic waste, even carcasses of farm animals.

TM AGRI works like a pump, this means that transports the drained water directly to the sewerage collectors of the private purification plants.

TM AGRI is made up by:

- ✚ Waste-crushing disposer Model TM 451;
- ✚ Loading group with endless screw system.

DESCRIPTION

Technical data:

- Crusher set of 5.5 HP;
- Three-phase motor 220-380 V. – 50 HZ. 5.5 HP;
- Motor-reducer of 1,5 HP for the cochlea;
- Thrust Cochlea (conveyor);
- Starting Current: with EC standards 21-12 A;
- Hydraulic circuit starting with servo-controlled electro-valve at automatic input;
- Ancillary controls (24V) with Switch buttons (reverse, stop, forward) with heat protection;
- Exhaust diameter: 1-1/2" threaded;
- Waste input: 300X300 mm.

Equipped with:

- Stainless-steel A.1.S.1.304 mobile structure;
- Stainless-steel tank with safety system for accident prevention.

Size:

- Height: 850 mm;
- Width: 400 mm;
- Depth: 1300 mm;
- Weight: 150 Kg.

Different Voltage available by request.



PULPER SERIES REMOTE CONFIGURATIONS

Besides VIDOTTO's built-in unit PULPERS, there is also a remote series: as you can see in the picture, every VIDOTTO garbage disposer can be combined with the corresponding C2 FILTER, obtaining a remote system.

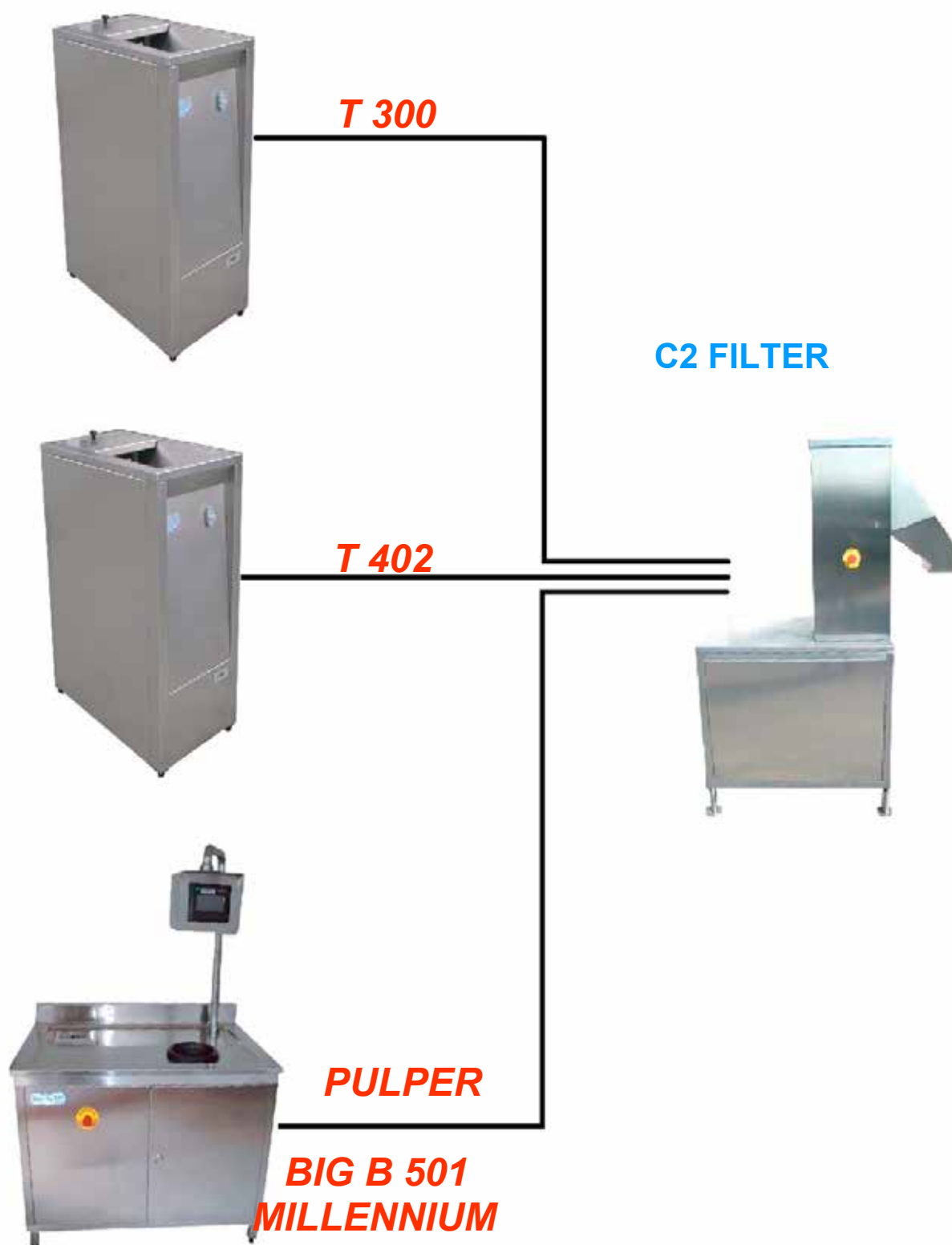

CRUSHING DISPOSER OF GLASS BOTTLES: ARCHIMEDE

The crushing disposer Model ARCHIMEDE is for the crushing of glass bottles and glass containers, in order to reduce their volume.

DESCRIPTION

Technical data:

- Stainless-steel crusher set of 1.5 HP;
- Three-phase or motor 220-380 V. – 50 HZ. 1.5 HP;
- Starting Current: with EC standards 4-2,4 A;
- Hydraulic circuit with electro-valve and automatic input;
- Ancillary controls (24V) with Switch buttons (reverse, stop, forward) with heat protection;
- Exhaust diameter: 40 mm;
- Disposal capacity: 70-100 kg/h.

Equipped with:

- Stainless-steel container A.1.S.1.304;
- Stainless-steel structural frame A.1.S.1.304 to fit the disposer set;
- Safety system in the hopper for the prevention of accidents;
- Flexible metal hose of 120 cm of $\frac{3}{4}$ " (for the link with the water channel)
- Special siphon in mopen;
- Service key for the manual unblocking;

Size:

- Height: 1050 mm;
- Width: 400 mm;
- Depth: 800 mm;
- Weight: 100 kg.

Different Voltage available by request.



PULPER SERIES

Besides the built-in unit 'pulper' systems, VIDOTTO DISSIPATORI offers a wide range of remote disposers called "PULPER SERIES".

Every VIDOTTO disposer can be combined matching one-by-one the C2 filter with the chosen disposer.

Our technical office is at your beck and call for any other additional information and for suggestions about the shaping of the instruments.

FILTER COMPACTOR C/2

This system allows to recover all the materials non transportable towards the sewers.

With the C/2 FILTER COMPACTOR, VIDOTTO offers a wide range of possible solutions for the built in-unit and remote installations. These structures can have an upright classical version, or can be produced with the new horizontal configuration.

C/2 FILTER COMPACTOR is applicable, according to the (ISO) sizes on to these waste disposers:

- ✚ Z 106;
- ✚ T 402;
- ✚ B 501;
- ✚ B 701.

Technical data:

- The power changes according to the selected model;
- Voltage: 220/380 V
- Frequency: 50/60 Hz.
- Ancillary controls (24V);
- Stainless-steel structure A.1.S.1.304
- Waste press;
- Water pump.



				VPS		VPL		
		Length		Depth1		Depth2		Height
Z 106	=	500	=	700	=	500	=	1900
T 300	=	500	=	700	=	800	=	1900
T 402	=	500	=	700	=	800	=	1900
B 501	=	700	=	700	=	800	=	1900
B 701	=	900	=	2000	=	200	=	1900

Caution: The depth changes according to the configuration of the drain projection.

VPS: Posterior drainage projection
VPL: Lateral drainage projection

**Different Voltage
available by request**

BUILT IN-UNIT SERIES: PULPER BIG T 300

The PULPER BIG T 300 includes:

- ✚ T 300 of 3 HP Disposers;
- ✚ Waste press filter C2 of 1,5 HP;
- ✚ Water pump of 1 HP.

Technical data:

- Three-phase motor of 3 HP;
- Voltage: 220/380 V;
- Frequency: 50 Hz;
- Ancillary controls with low voltage (24V) in a 1P 55 box.
- Safety System for the prevention of accidents (continuous cycle) inside the stainless-steel hopper;
- Hydraulic circuit starting with water input;
- Switch buttons (reverse, stop, forward);
- Exhaust diameter: 3" Ø;
- Disposal capacity: 150-250 kg/h.
- Stainless-steel structure;
- Stainless-steel structural frame to fit the disposer set;
- Pulping machine in alloy with an high standard of carbon and nickelchrome;
- Disinfectant pump;
- Magnet for cutlery or metallic parts.

Size:

- Height: 1800 mm;
- Length: 1300 mm
- Width: 700 mm;
- Net Weight: 187 kg.
- Gross Weight with the packaging: 210 kg.

Accessories:

- Loading channel for the extension of the pre-disposal place.

Different Voltage available by request.



BUILT IN-UNIT SERIES: PULPER BIG T 401 and PULPER BIG T 402

The PULPER BIG T 401 and the PULPER BIG T 402 include:

- ✚ Disposers of 4 HP;
- ✚ Waste press filter C2 of 1,5 HP;
- ✚ Water pump of 1 HP.

Technical data:

- Three-phase motor of 4 HP;
- Voltage: 220/380 V;
- Frequency: 50 Hz;
- Ancillary controls with low voltage (24V) in a 1P 55 box.
- Safety System for the prevention of accidents (continuous cycle) inside the stainless-steel hopper;
- Hydraulic circuit starting with water input;
- Switch buttons (reverse, stop, forward);
- Exhaust diameter: 3" Ø;
- Disposal capacity: 250-350 kg/h.
- Stainless-steel structure;
- Stainless-steel structural frame to fit the disposer set;
- Pulping machine in alloy with an high standard of carbon and nickelchrome;
- Disinfectant pump;
- Magnet for cutlery or metallic parts.

Size:

- Height: 1800 mm;
- Length: 1300 mm
- Width: 700 mm;
- Net Weight: 187 kg.
- Gross Weight with the packaging: 210 kg.

Accessories:

- Loading channel for the extension of the pre-disposal place.

Different Voltage available by request.



PULPER WITH WATER-PRESS: PULPER BIG B 501

The PULPER BIG B 501 includes:

- + Disposer of 5,5 HP;
- + Waste press filter C2 of 1,5 HP;
- + Water pump of 1 HP.

Technical data:

- Three-phase motor of 5,5 HP;
- Voltage: 220/380 V;
- Frequency: 50 Hz;
- Watertight ancillary controls with low voltage (24V) in a 1P 55 box.
- Safety System for the prevention of accidents (continuous cycle) inside the stainless-steel hopper;
- Hydraulic circuit starting with water input;
- Switch buttons (reverse, stop, forward);
- Exhaust diameter: 3" Ø;
- Disposal capacity: 350-450 kg/h.
- Stainless-steel structure;
- Stainless-steel structural frame to fit the disposer set;
- Pulping machine in alloy with an high standard of carbon and nickelchrome;
- Disinfectant pump;
- Magnet for cutlery or metallic parts.

Size:

- Height: 1900 mm;
- Length: 1600 mm
- Width: 900 mm;
- Net Weight: 350 kg.
- Gross Weight with the packaging: 390 kg

Accessories:

- Loading channel for the extension of the pre-disposal place.

Different Voltage available by request.



PULPER WITH WATER-PRESS: PULPER BIG B 701

The PULPER BIG B 701 includes:

- + Disposer of 7,5 HP;
- + Waste press filter of 2 HP;
- + Water pump of 1 HP.

Technical data:

- Three-phase motor of 7,5 HP;
- Voltage: 220/380 V;
- Frequency: 50 Hz;
- Ancillary controls with low voltage (24V) in a 1P 55 box.
- Watertight protection 1P 55
- Safety System for the prevention of accidents (continuous cycle) inside the stainless-steel hopper;
- Hydraulic circuit starting with water input;
- Switch buttons (reverse, stop, forward);
- Exhaust diameter: 3" Ø;
- Disposal capacity: 650-750 kg/h.
- Stainless-steel structure;
- Stainless-steel structural frame to fit the disposer set;
- Crusher components in alloy with an high standard of carbon and nickelchrome;
- Disinfectant pump;
- Magnet for cutlery or metallic parts.

Size:

- Height: 1900 mm;
- Length: 1600 mm
- Width: 900 mm;
- Net Weight: 450 kg.
- Gross Weight with the packaging: 490 kg

Accessories:

- Loading channel for the extension of the pre-disposal place.

Different Voltage available by request.



REMOTE PULPER: PULPER BIG 501 MILLENNIUM

The remote PULPER BIG 501 millennium includes:

- ✚ Disposer Mod. B 501 (to combine with the C2 filter);
- ✚ Crusher set of 5,5 HP;

Technical data:

- Three-phase motor of 5,5 HP;
- Voltage: 220/380 V;
- Frequency: 50 Hz;
- Ancillary controls with touch screen display;
- Safety System in the basin for the prevention of accidents (continuous cycle) inside the hopper;
- Hydraulic circuit starting with water input;
- Switch buttons (reverse, stop, forward);
- Net connection;
- Exhaust diameter: 3" Ø;
- Disposal capacity: 450-550 kg/h.
- Stainless-steel structure A.1.S.1.304;
- Stainless-steel structural frame to fit the disposer set;
- Crusher components in alloy with an high standard of carbon and nickelchrome;
- Totally automatic cycle;
- Disinfectant pump;
- Magnet for cutlery or metallic parts.
- Automatic exhaust valve;
- Automatic washing cycle.

Size:

- Height of the worktop: 850 mm;
- Total height: 1900 mm;
- Length: 1600 mm
- Width: 900 mm;
- Net Weight: 370 kg.
- Gross Weight with the packaging: 400 kg

Different Voltage available by request.



REMOTE PULPER: PULPER BIG 701 MILLENNIUM

The remote PULPER BIG 701 millennium includes:

- ✚ Disposer Mod. B 701 (to combine with the C2 filter);
- ✚ Crusher set of 7,5 HP;

Technical data:

- Three-phase motor of 7,5 HP;
- Voltage: 220/380 V;
- Frequency: 50 Hz;
- Ancillary controls with touch screen display;
- Safety System in the basin for the prevention of accidents (continuous cycle) inside the hopper;
- Hydraulic circuit starting with water input;
- Switch buttons (reverse, stop, forward);
- Net connection;
- Exhaust diameter: 3" Ø;
- Disposal capacity: 650-750 kg/h.
- Stainless-steel structure A.1.S.1.304;
- Stainless-steel structural frame to fit the disposer set;
- Crusher components in alloy with an high standard of carbon and nickelchrome;
- Disinfectant pump;
- Magnet for cutlery or metallic parts.
- Automatic exhaust valve;
- Returning sewage.

Size:

- Height of the worktop: 850 mm;
- Total height: 1900 mm;
- Length: 1600 mm
- Width: 900 mm;
- Net Weight: 470 kg.
- Gross Weight with the packaging: 500 kg

Different Voltage available by request.



GARBAGE PRESSES FOR SMALL SPACES: MINI-PRESS C5

The mini-press C5 is a small power press by hand that must be installed on the wall. It is made up by a set of presses by hand, conceived for pressing aluminium milk containers up to 5 l H. 850; C5 is ideal for pizzerias and restaurants.



GARBAGE PRESSES FOR SMALL SPACES: ELECTRICAL GARBAGE PRESS C1

C1 is a pressing set that can be kept under the launch counter: ideal for bars, coffee houses, restaurants, chalets, laboratories, doctors and even homes.

Technical data:

- Power: 20 N/cm;
- Pressure 22 KN;
- Current: 3-polig. 230 V. 50 Hz. 0.25 KW;
- Holding capacity: 30 lt.

Size:

- Length: 700 mm
- Width: 400 mm;
- Height: 850 mm.

Different Voltage available by request.



TIN PRESS – ECOPRESS T15

Food waste compactor

Working in large kitchens creates always a large quantity of waste such as boxes, tins, bottles, and many other types of packaging, that, if is not removed and stored up, may be dangerous for our health and security.

The compactor ECOPRESS T15 is a basic model, and is recommended for restaurants, hotels, nurseries, business places, university and hospital canteens, fast foods, etc. It is also recommended for the reduction of waste in large confectioneries, industries and ships.

The compactor ECOPRESS T15 reduces quickly the volume of waste of about the 80-85%, compressing inside plastic bags and creating pressed cubes ready for the neutralization.

ECOPRESS T15 has been studied for a reliable and long-lasting service. Its internal and external coverings are made of stainless-steel and it can be equipped with directional castor wheels, for the easing of its cleaning and maintenance. ECOPRESS T15 is exceptionally silent during its work processes and this makes of it the ideal machine for kitchens, but is also adaptable for external installations.

Technical data:

- Three-phase motor of 1,5 HP, 380 – 50 Hz;
- Starting current with EC standards of 6-2-9 A;
- Hopper input area: 500X700 mm with tinplate collection chest A.I.S.I.304 at EC standards;
- Controls at low voltage complete with Safety System
- Closure device for the containing bags of the pressed unit;
- Switch buttons (reverse, stop, forward);
- Stainless-steel structure A.I.S.I.304;
- Security system of the hatches;
- Maximum pressure: 15 bar;
- Collection basket A.I.S.I. 304 equipped with hand-truck for the moves;
- Collection capacity: 74 lt.

Size:

- Height: 1600 mm;
- Width: 500 mm;
- Depth: 700 mm.
- Weight: 265 Kg.

Different Voltage available by request.



TIN PRESS – ECOPRESS T30

Food waste compactor

Working in large kitchens creates always a large quantity of waste such as boxes, tins, bottles, and many other types of packaging, that, if is not removed and stored up, may be dangerous for our health and security.

The compactor ECOPRESS T30 is recommended for restaurants, hotels, nurseries, business places, university and hospital canteens, fast foods, etc. It is also recommended for the reduction of waste in large confectioneries, industries and ships.

The compactor ECOPRESS T30 reduces quickly the volume of waste of about the 80-85%, compressing inside plastic bags and creating pressed cubes ready for the neutralization.

ECOPRESS T30 has been studied for a reliable and long-lasting service. Its internal and external coverings are made of stainless-steel and it can be equipped with directional castor wheels, for the easing of its cleaning and maintenance. ECOPRESS T15 is exceptionally silent during its work processes and this makes of it the ideal machine for kitchens, but is also adaptable for external installations.

Technical data:

- Three-phase motor of 1,5 HP, 380 – 50 Hz;
- Starting current with EC standards of 10-6 A;
- Hopper input area: 600X600 mm with tinplate collection chest A.I.S.I.304 at EC standards;
- Controls at low voltage complete with Safety System
- Closure device for the containing bags of the pressed unit;
- Switch buttons (reverse, stop, forward);
- Stainless-steel structure A.1.S.1.304;
- Security system of the hatches;
- Maximum pressure: 30 bar;
- Collection basket A.I.S.I. 304 equipped with hand-truck for the moves;
- Collection capacity: 108 lt.

Size:

- Height: 1900 mm;
- Width: 700 mm;
- Depth: 700 mm.
- Weight: 365 Kg.

Different Voltage available by request.



ECOPRESS FE SERIES

Suitable for the grinding of big cardboards, tins and packages that can damage the health and the safety, until they do not get disposed of.

The compactor reduces the volume of the wastes of circa 80-85% and the output material is ready for the neutralization, compacted into pressed cubes, with a final ligature.

The compactor is designed for a long-lasting and safe use, and can be equipped with more than one tank for the pressure. It is very silent representing a device that can be applied in any place, also for external plants.

This press is suggested for communities, commercial activities, hotels, nurseries, university and factory canteens, hospitals, fast foods, industries and all the other facilities in which there are many people.

Technical data:

- Grinding set: 1,1 KW;
- Motor: three phase, 380 V; 50 Hz;
- Pressing mass force: 10/12 Tons.;
- Pressure: 90/100 bar;
- Cycle duration: 30 sec.;
- Pressing space: mm700 x 600 x 1300;
- Input opening: mm. 500 x 400;
- Maximum size of the bale: mm. 500 x 400 x 800;
- Bale weight: from 30 up to 40 Kg.;
- Legature: nr. 04;

Size:

Complete structure:

Height = 1.400 mm;

Width = 500 mm;

Length = 600 mm;

Pressing space sizes:

- Input opening: mm 700 x 500
- Height: 800 mm

Different Voltage available by request.

Different sizes and configurations are available by request.



SHREDDER: ERACLE A4/A7/A22

The shredder ERACLE A4 patented by VIDOTTO DISSIPATORI is conceived and produced as a machine able to crush glass, plastic, tins, small cylinders, paper boxes, wooden boxes, shavings or small metallic pieces, animal bones and other organic materials.

Technical data:

- Crusher set of 4 Kw;
- Motor of 5.5 Hp;
- Voltage: 220/240 – 380/440 V.
- Frequency: 50 Hz;
- Starting current of 16-14, 10-8 A at EC standards;
- Crusher components in alloy and high standard of carbon and nickelchrome;
- Hopper input area: 450X450 mm, depth 600 mm;
- Safety System inside the hopper for the prevention of accidents;
- Thickness of the cutters: 5-10-15 mm;
- Transmission at two shafts;
- Speed of shafts: 8-16 RPM.

Size:

- Height: 2700 mm;
- Width: 1000 mm;
- Depth: 1000 mm;
- Weight: 750 Kg.

Different Voltage available by request.

Different sizes and configurations are available by request.



DIFFERENTIATED COLLECTION: ECOSATELLITE ERACLE A4

The ECOSATELLITE ERACLE A4 patented by VIDOTTO DISSIPATORI is conceived and produced as a machine able to select and crush in order to make the separate collection of the rubbish, crushing glass, plastic, tins, small cylinders, paper boxes, wooden boxes, shavings or small metallic pieces, animal bones and other organic materials.

ECOSATELLITE ERACLE A4 moves automatically above the different containers in which the different collected materials must be placed.

Technical data:

- Crusher set of 4 Kw;
- Motor of 5.5 Hp;
- Voltage: 220/240 – 380/440 V.
- Frequency: 50 Hz;
- Starting current of 16-14, 10-8 A at EC standards;
- Crusher components in alloy and high standard of carbon and nickelchrome;
- Hopper input area: 450X450 mm, depth 600 mm;
- Safety System inside the hopper for the prevention of accidents;
- Thickness of the cutters: 5-10-15 mm;
- Transmission at two shafts;
- Speed of shafts: 8-16 RPM.
- Collection in 4 units, at Euro standards.

Size:

- Height: 2700 mm;
- Width: 3700 mm;
- Depth: 1020 mm;
- Weight: 1250 Kg.

Different Voltage available by request.

Different sizes and configurations are available by request.



SHREDDERS ERACLE VG SERIES

The shredders mod. ERACLE VG, work through electric motor or driving pumping systems, and are available with many shredding inlet lengths.

These shredders are low-speed machines and are composed by a gear box and two counter revolving hexagonal shafts.

ERACLE VG shredders are equipped with a device that controls automatically the overload and with a motor protector.



TECHNICAL SCHEME OF ELECTRIC ERACLE VG SHREDDERS

MODEL	DESCRIPTION	TECHNICAL DATA
ERACLE VG KW 7,5/350 HP 10 100-180 Kg/h	<ul style="list-style-type: none"> - Drive of the electric motor - Shredder with structure, standard hopper and electric components Optional: <ul style="list-style-type: none"> - Mono-multi hook shafts from 10mm to 50mm - Gear bulkheads - Inclined hopper (for boxes, and barrels) - Presser 	Power: 7,5 KW Current consumption: 15 A Motor: Three phase Number of shafts: 2 Shredding space: 350x500 Average disposal capacity: 100-180 kg
ERACLE VG KW 7,5/420 HP 10 150-300 Kg/h	<ul style="list-style-type: none"> - Drive of the electric motor - Shredder with structure, standard hopper and electric components Optional: <ul style="list-style-type: none"> - Mono-multi hook shafts from 10mm to 50mm - Gear bulkheads - Inclined hopper (for boxes, and barrels) - Presser 	Power: 7,5 KW Current consumption: 15 A Motor: Three phase Number of shafts: 2 Shredding space: 420x500 Average disposal capacity: 150-300 kg
ERACLE VG KW 7,5/480 HP 10 180-380 Kg/h	<ul style="list-style-type: none"> - Drive of the electric motor - Shredder with structure, standard hopper and electric components Optional: <ul style="list-style-type: none"> - Mono-multi hook shafts from 10mm to 50mm - Gear bulkheads - Inclined hopper (for boxes, and barrels) - Presser 	Power: 7,5 KW Current consumption: 15 A Motor: Three phase Shredding space: 480x500 Number of shafts: 2 Average disposal capacity: 180-300 kg
ERACLE VG KW 11/500 HP 15 200-500 Kg/h	<ul style="list-style-type: none"> - Drive of the electric motor - Shredder with structure, standard hopper and electric components Optional: <ul style="list-style-type: none"> - Mono-multi hook shafts from 10mm to 50mm - Gear bulkheads - Inclined hopper (for boxes, and barrels) - Presser 	Power: 11 KW Current consumption: 22 A Motor: Three phase Shredding space: 500x600 Number of shafts: 2 Average disposal capacity: 200-500 kg
ERACLE VG KW 11/600 HP 15 200-600 Kg/h	<ul style="list-style-type: none"> - Drive of the electric motor - Shredder with structure, standard hopper and electric components Optional: <ul style="list-style-type: none"> - Mono-multi hook shafts from 10mm to 50mm - Gear bulkheads - Inclined hopper (for boxes, and barrels) - Presser 	Power: 11 KW Current consumption: 22 A Motor: Three phase Number of shafts: 2 Shredding space: 600x600 Average disposal capacity: 200-600 kg
ERACLE VG KW 15/1000 HP 20 700-1000 Kg/h	<ul style="list-style-type: none"> - Drive of the electric motor - Shredder with structure, standard hopper and electric components Optional: <ul style="list-style-type: none"> - Mono-multi hook shafts from 10mm to 50mm - Gear bulkheads - Inclined hopper (for boxes, and barrels) - Presser 	Power: 15 KW Current consumption: 30 A Motor: Three phase Shredding space: 1000x600 Number of shafts: 2 Average disposal capacity: 700-1000 kg
ERACLE VG KW 22/1250 HP 30 800-1200 Kg/h	<ul style="list-style-type: none"> - Drive of the electric motor - Shredder with structure, standard hopper and electric components Optional: <ul style="list-style-type: none"> - Mono-multi hook shafts from 10mm to 50mm - Gear bulkheads - Inclined hopper (for boxes, and barrels) - Presser 	Power: 22 KW Current consumption: 45 A Motor: Three phase Shredding space: 1250x600 Number of shafts: 2 Average disposal capacity: 800-1200 kg

TECHNICAL SCHEME OF IDRAULIC OR PRESSING POWER ERACLE VG SHREDDERS

MODEL	DESCRIPTION	TECHNICAL DATA
ERACLE VG KW 22/750 HP 30 500-1800 Kg/h	<ul style="list-style-type: none"> - Drive of the hydraulic motor - Shredder with hydraulic and electric motor drive, without structure, but equipped with hopper Optional: <ul style="list-style-type: none"> -Structure -Gardanic clamping force - Mono-multi hook shafts from 30mm to 80mm - Inclined hopper (for boxes, and barrels) - Presser 	Power: 22 KW Current consumption: 45 A Motor: Three phase pump Number of shafts: 2 Hydraulic motor: 2 Shredding area: 1000x850 Average disposal capacity: 550-1900 kg
ERACLE VG KW 22/1000 HP 30 550-1900 Kg/h	<ul style="list-style-type: none"> - Drive of the hydraulic motor - Shredder with hydraulic and electric motor drive, without structure, but equipped with hopper Optional: <ul style="list-style-type: none"> -Structure -Gardanic clamping force - Mono-multi hook shafts from 30mm to 80mm - Inclined hopper (for boxes, and barrels) - Presser 	Power: 22 KW Current consumption: 45 A Motor: Three phase pump Number of shafts: 2 Hydraulic motor: 2 Shredding area: 760x850 Average disposal capacity: 500-1800 kg
ERACLE VG KW 22/1250 HP 30 650-2600 Kg/h	<ul style="list-style-type: none"> - Drive of the hydraulic motor - Shredder with hydraulic and electric motor drive, without structure, but equipped with hopper Optional: <ul style="list-style-type: none"> -Structure -Gardanic clamping force - Mono-multi hook shafts from 30mm to 80mm - Inclined hopper (for boxes, and barrels) - Presser 	Power: 22 KW Current consumption: 45 A Motor: Three phase pump Number of shafts: 2 Hydraulic motor: 2 Shredding area: 1260x850 Average disposal capacity: 650-2600 kg
ERACLE VG KW 37/750 HP 50 700-2800 Kg/h	<ul style="list-style-type: none"> - Drive of the hydraulic motor - Shredder with hydraulic and electric motor drive, without structure, but equipped with hopper Optional: <ul style="list-style-type: none"> -Structure -Gardanic clamping force - Mono-multi hook shafts from 30mm to 80mm - Inclined hopper (for boxes, and barrels) - Presser 	Power: 37 KW Current consumption: 70 A Motor: Three phase pump Number of shafts: 2 Hydraulic motor: 2 Shredding area: 750x850 Average disposal capacity: 700-2800 kg
ERACLE VG KW 37/1000 HP 50 700-2900 Kg/h	<ul style="list-style-type: none"> - Drive of the hydraulic motor - Shredder with hydraulic and electric motor drive, without structure, but equipped with hopper Optional: <ul style="list-style-type: none"> -Structure -Gardanic clamping force - Mono-multi hook shafts from 30mm to 80mm - Inclined hopper (for boxes, and barrels) - Presser 	Power: 37 KW Current consumption: 70 A Motor: Three phase pump Number of shafts: 2 Hydraulic motor: 2 Shredding area: 1000x850 Average disposal capacity: 700-2900 kg
ERACLE VG KW 37/1250 HP 50 800-3000 Kg/h	<ul style="list-style-type: none"> - Drive of the hydraulic motor - Shredder with hydraulic and electric motor drive, without structure, but equipped with hopper Optional: <ul style="list-style-type: none"> -Structure -Gardanic clamping force - Mono-multi hook shafts from 30mm to 80mm - Inclined hopper (for boxes, and barrels) - Presser 	Power: 37 KW Current consumption: 70 A Motor: Three phase pump Number of shafts: 2 Hydraulic motor: 2 Shredding area: 1250x850 Average disposal capacity: 800-3000 kg

COMBINED SYSTEMS

MODEL	DESCRIPTION	TECHNICAL DATA
ERACLE VG KW 11/500 HAMMERED MILL 22KW	<ul style="list-style-type: none"> - Set with n° 1 ERACLE KW on a hammered mill. - Payload: 130-310 Kg. 	Power: 11 KW Current consumption: 22 A Average disposal capacity: 130-310 kg
ERACLE VG KW 11/600 HAMMERED MILL 22KW	<ul style="list-style-type: none"> - Set with n° 1 ERACLE KW on a hammered mill. - Payload: 190-510 Kg. 	Power: 11 KW Current consumption: 22 A Average disposal capacity: 190-510 kg

Different sizes and configurations are available by request



SHREDDERS ERACLE VG/I SERIES

Shredders of the series mod.ERACLE VG/I, are made up with a driving pumping system and are available with many shredding inlet lengths.

ERACLE VG/I shredders are Low-speed devices, composed by a gear box and two counter revolving hexagonal shafts.

These shredders are equipped with an automatic overload device and a motor thermal protection.



TECHNICAL SCHEME OF IDRAULIC OR PRESSING POWER ERACLE VG/I SHREDDERS

MODEL	DESCRIPTION	TECHNICAL DATA
ERACLE VG/I KW 22/750 HP 30 500-1800 Kg/h	<ul style="list-style-type: none"> - Drive of the hydraulic motor - Shredder with hydraulic and electric motor drive, without structure, but equipped with hopper Optional: <ul style="list-style-type: none"> -Structure -Gardanic clamping force - Mono-multi hook shafts from 30mm to 80mm - Inclined hopper (for boxes, and barrels) - Presser 	Power: 22 KW Current consumption: 45 A Motor: Three phase pump Number of shafts: 2 Hydraulic motor: 2 Shredding area: 1000x850 Average disposal capacity: 500-1800 kg
ERACLE VG/I KW 22/1000 HP 30 550-1900 Kg/h	<ul style="list-style-type: none"> - Drive of the hydraulic motor - Shredder with hydraulic and electric motor drive, without structure, but equipped with hopper Optional: <ul style="list-style-type: none"> -Structure -Gardanic clamping force - Mono-multi hook shafts from 30mm to 80mm - Inclined hopper (for boxes, and barrels) - Presser 	Power: 22 KW Current consumption: 45 A Motor: Three phase pump Number of shafts: 2 Hydraulic motor: 2 Shredding area: 760x850 Average disposal capacity: 550-1900 kg
ERACLE VG/I KW 22/1250 HP 30 650-2600 Kg/h	<ul style="list-style-type: none"> - Drive of the hydraulic motor - Shredder with hydraulic and electric motor drive, without structure, but equipped with hopper Optional: <ul style="list-style-type: none"> -Structure -Gardanic clamping force - Mono-multi hook shafts from 30mm to 80mm - Inclined hopper (for boxes, and barrels) - Presser 	Power: 22 KW Current consumption: 45 A Motor: Three phase pump Number of shafts: 2 Hydraulic motor: 2 Shredding area: 1260x850 Average disposal capacity: 650-2600 kg
ERACLE VG/I KW 37/750 HP 50 700-2800 Kg/h	<ul style="list-style-type: none"> - Drive of the hydraulic motor - Shredder with hydraulic and electric motor drive, without structure, but equipped with hopper Optional: <ul style="list-style-type: none"> -Structure -Gardanic clamping force - Mono-multi hook shafts from 30mm to 80mm - Inclined hopper (for boxes, and barrels) - Presser 	Power: 37 KW Current consumption: 70 A Motor: Three phase pump Number of shafts: 2 Hydraulic motor: 2 Shredding area: 750x850 Average disposal capacity: 700-2800 kg
ERACLE VG/I KW 37/1000 HP 50 700-2900 Kg/h	<ul style="list-style-type: none"> - Drive of the hydraulic motor - Shredder with hydraulic and electric motor drive, without structure, but equipped with hopper Optional: <ul style="list-style-type: none"> -Structure -Gardanic clamping force - Mono-multi hook shafts from 30mm to 80mm - Inclined hopper (for boxes, and barrels) - Presser 	Power: 37 KW Current consumption: 70 A Motor: Three phase pump Number of shafts: 2 Hydraulic motor: 2 Shredding area: 1000x850 Average disposal capacity: 700-2900 kg
ERACLE VG/I KW 37/1250 HP 50 800-3000 Kg/h	<ul style="list-style-type: none"> - Drive of the hydraulic motor - Shredder with hydraulic and electric motor drive, without structure, but equipped with hopper Optional: <ul style="list-style-type: none"> -Structure -Gardanic clamping force - Mono-multi hook shafts from 30mm to 80mm - Inclined hopper (for boxes, and barrels) - Presser 	Power: 37 KW Current consumption: 70 A Motor: Three phase pump Number of shafts: 2 Hydraulic motor: 2 Shredding area: 1250x850 Average disposal capacity: 800-3000 kg

ERACLE VG/I KW 55/1250 HP 75 900-3100 Kg/h	<ul style="list-style-type: none"> - Drive of the hydraulic motor - Shredder with hydraulic and electric motor drive, without structure, but equipped with hopper Optional: <ul style="list-style-type: none"> -Structure -Gardanic clamping force - Mono-multi hook shafts from 30mm to 80mm - Inclined hopper (for boxes, and barrels) - Presser 	Power: 55 KW Current consumption: 110 A Motor: Three phase pump Number of shafts: 2 Hydraulic motor: 2 Shredding area: 1250x850 Average disposal capacity: 900-3100 kg
ERACLE VG/I KW 75/1250 HP 50 1000-3500 Kg/h	<ul style="list-style-type: none"> - Drive of the hydraulic motor - Shredder with hydraulic and electric motor drive, without structure, but equipped with hopper Optional: <ul style="list-style-type: none"> -Structure -Gardanic clamping force - Mono-multi hook shafts from 30mm to 80mm - Inclined hopper (for boxes, and barrels) - Presser 	Power: 75 KW Current consumption: 150 A Motor: Three phase pump Number of shafts: 2 Hydraulic motor: 2 Shredding area: 1250x850 Average disposal capacity: 1000-3500 kg
ERACLE VG/I KW 110/1250 HP 150 1200-4000 Kg/h	<ul style="list-style-type: none"> - Drive of the hydraulic motor - Shredder with hydraulic and electric motor drive, without structure, but equipped with hopper Optional: <ul style="list-style-type: none"> -Structure -Gardanic clamping force - Mono-multi hook shafts from 30mm to 80mm - Inclined hopper (for boxes, and barrels) - Presser 	Power: 110 KW Current consumption: 220 A Motor: Three phase pump Number of shafts: 2 Hydraulic motor: 2 Shredding area: 1250x850 Average disposal capacity: 1200-4000 kg

CUSTOM MADE PLANTS FOR SHIPS, COMMUNITIES AND FORSU TREATING PLANTS.

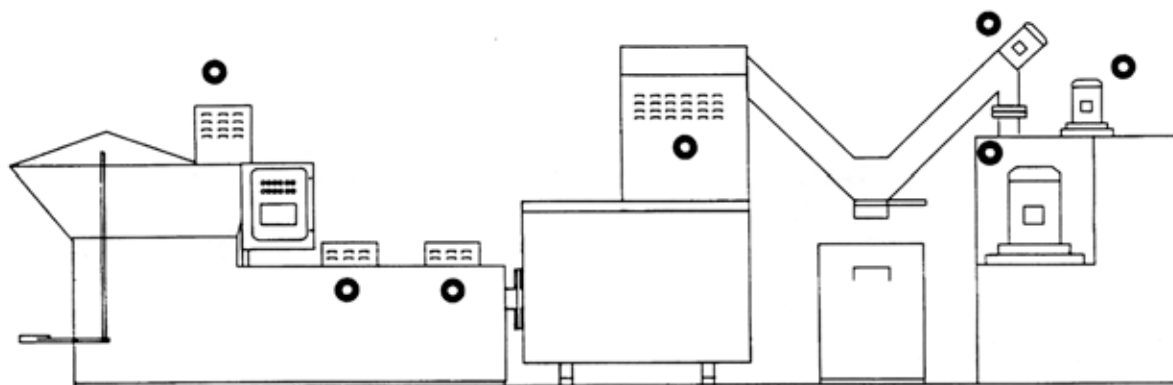
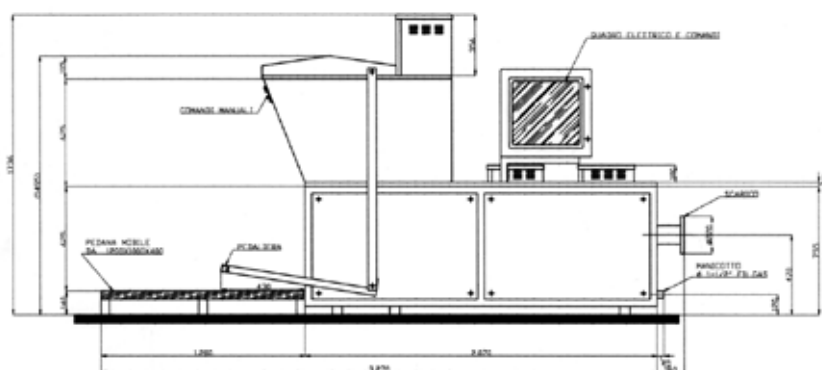
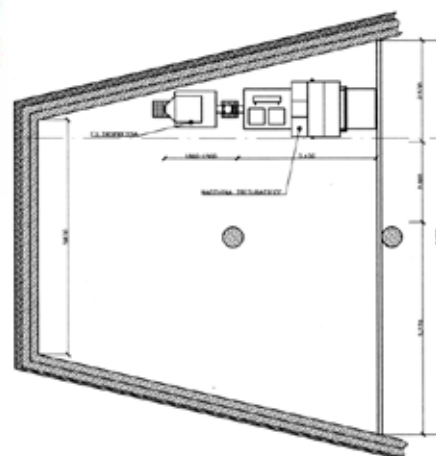





GENERAL CONDITIONS

- ✚ Enclosed with this catalogue there is a price list whose latest revision completely deletes and substitutes the previous ones;
- ✚ Voltage and power source standards are 220-380 Volt, 50 Hz. For special voltages there is a surcharge of the price;
- ✚ Warranty is of 24 months: it includes the free replacement of the faulty pieces (returned free of charge from Eraclea);
- ✚ The possible maintenance service will be invoiced according to the Assocomplast lists.
- ✚ The prices of the goods include the packaging, are V.A.T. excluded and are to be intended as EXW from Eraclea.
- ✚ The technical data explained inside this catalogue are just informative.
- ✚

DOMESTIC GARBAGE DISPOSER MIO Z 104	pag. 3
GARBAGE DISPOSAL AIR SWITCH	pag. 4
KIT SIPHON AND PLUGHOLE SET	pag. 5
DOMESTIC GARBAGE DISPOSER Z 105	pag. 6
DOMESTIC GARBAGE DISPOSER WITH PUMP EFFECT Z 105/P	pag. 7
DISPOSER FOR SMALL COMMUNITIES Z 106	pag. 8
DISPOSER FOR SMALL COMMUNITIES WITH PUMP EFFECT Z 106/P	pag. 9
DISPOSER FOR SMALL COMMUNITIES Z 106 INOX	pag. 10
DISPOSER FOR SMALL COMMUNITIES Z 106 INOX SPECIAL	pag. 11
DISPOSER FOR COMMUNITIES T 300	pag. 12
DISPOSER FOR COMMUNITIES: T 421 Garbage disposer with simple milling process	pag. 13
DISPOSER FOR COMMUNITIES: T 402 Garbage disposer with simple milling process	pag. 14
DISPOSER FOR COMMUNITIES: T 402 MT Garbage disposer with simple milling process	pag. 15
PRE-WASHING FOR DISHWASHERS: T 421 SPECIAL Garbage disposer with simple milling process	pag. 16
WORKTABLE KOMBI 2000 With waste-crushing disposer	pag. 17
DISPOSER FOR COMMUNITIES: B 501 Double-milling process crushing-waste disposer	pag. 18
DISPOSER FOR COMMUNITIES: B 701 Double-milling process crushing-waste disposer	pag. 19
OPTIONAL ACCESSORIES Automatic device intercepting cutlery and iron materials Piletta Ø 240 – Rammer Ø 240	pag. 20
IN-LINE PUMP GRINDER FOR RAISING PLANTS: PUMP GRINDER TM 451	pag. 21
IMMERSION PUMP GRINDER FOR RAISING PLANTS: IMMERSION PUMP GRINDER TMS 451	pag. 22



ORGANIC WASTE DISPOSER: TM AGRI		pag. 23
GRINDING DISPOSER OF NAPPIES AND SANITARY TOWELS: TM LADY		pag. 24
CRUSHING DISPOSER OF GLASS BOTTLES: ARCHIMEDE		pag. 25
PULPER SERIES FILTER COMPACTOR C/2		pag. 26
BUILT IN-UNIT SERIES: PULPER BIG T 300		pag. 27
BUILT IN-UNIT SERIES: PULPER BIG T 401 and PULPER BIG T 402		pag. 28
PULPER WITH WATER-PRESS: PULPER BIG B 501		pag. 29
PULPER WITH WATER-PRESS: PULPER BIG B 701		pag. 30
REMOTE PULPER: PULPER BIG 501 MILLENNIUM		pag. 31
REMOTE PULPER: PULPER BIG 701 MILLENNIUM		pag. 32
EXAMPLE OF INSTALLATION OF REMOTE PULPERS		pag. 33
GARBAGE PRESSES FOR SMALL SPACES: MINI-PRESS C5		pag. 34
GARBAGE PRESSES FOR SMALL SPACES: ELECTRICAL GARBAGE PRESS C1		
TIN PRESS – ECOPRESS T15 Food waste compactor		pag. 35
TIN PRESS – ECOPRESS T30 Food waste compactor		pag. 36
ECOPRESS FE SERIES		pag. 37
SHREDDER: ERACLE A4/A7/A22		pag. 38
DIFFERENTIATED COLLECTION: ECOSATELLITE ERACLE A4		pag. 39
SHREDDERS ERACLE VG SERIES		pag. 40
SHREDDERS ERACLE VG/I SERIES		pag. 44
CUSTOM MADE PLANTS FOR SHIPS, COMMUNITIES AND FORSU TREATING PLANTS		pag. 47
GENERAL CONDITIONS		pag. 48