

Pullman washer extractors

WP4700H, WP4900H, WP41100H

Features and benefits

- Two compartment inner drum separated by a Pullman partition for the best ergonomics and mechanical action on the market
- Automatic inner drum positioning in loading or unloading position
- Automatic locking and unlocking of outer drum doors
- Largest doors on the market
- Unloading by gravity, the easiest and fastest on the market
- Intuitive programming control panel
 - 8 colour industrial touch screen
 - Smart card reader & writer
 - Electrolux unfolding menus
 - Choice of 14 languages
- Pneumatic suspension for minimum vibrations
- Frequency control motor and Poly V belt for precise, consistent and silent rotation speeds
- 5 compartment soap box for manual supply or connection to automatic liquid system



Main options

- Electrolux Integrated Weighing System for better ergonomics and productivity
- Integrated pH meter for a better performing traceability
- Automatic opening of inner drum doors at the end of the washing cycle
- Titration valve for bath sampling
- End of cycle sound and visual alarm
- Stainless steel cover panels
- Third water inlet
- Second drain valve for water recycling

Main specifications			WP4700H		WP4900H		WP41100H	
Rated capacity,	filling factor 1:10	kg/lb	70/154		90/198		110/242	
	filling factor 1:13	kg/lb	54/118		69/152		84/184	
Drum	volume	litre	690		890		1080	
	diameter	ø mm	1050		1050		1050	
Extraction		rpm	720		720		720	
G-factor			300		300		300	
Heating alternatives	electricity	kW	54		72		72	
	steam		x		x		x	
Consumption data "Normal 65°C" typical wash cycle with pre-wash*			Electric	Steam	Electric	Steam	Electric	Steam
Water consumption (cold)	litre		990	990	1190	1190	1490	1490
Energy consumption (motor/heating)*	kWh/h		1.78/15	1.78	2.3/24.3	2.3	2.4/25.3	2.4
Steam consumption	kg		-	24	-	32	-	36
Compressed air consumption	litre		50	50	50	50	50	50

* Typical cycle (filling 1/10) prewash 3 mn 35°C, drain 2 mn, main wash 4 mn 65°C, drain 2 mn, rinse 2 mn distribution 2 mn, rinse 2 mn, extraction 2 mn, rinse 2 mn, extraction 10 mn (cold water temperature 15°C).

Certified in accordance with ISO 9001 and ISO 14001 and approved IP 24D.

Electrical connections*			WP4700H	WP4900H	WP41100H
Heating Voltage					
Electric	380-415V 3 AC 50/60 Hz	kW(A)	65.7 (125)	87.7 (160)	91 (160)
Steam or non-heated	380-415V 3 AC 50/60 Hz	kW(A)	11.7 (40)	15.7 (40)	19 (50)
Water and steam connections					
Water valves	DN		32	32	32
Water pressure	kPa		50-600	50-600	50-600
Capacity at 250 kPa	l/min		200	200	200
Drain valve	ø mm		110	110	110
Draining capacity	l/min		380	380	380
Steam valve	DN		25	25	25
Steam pressure	kPa		300-600	300-600	300-600
Compressed air	ø mm		6/8	6/8	6/8
Compressed air pressure	kPa		550-700	550-700	550-700
Sound levels					
Airborne sound level (washing/extraction)					
	dB(A)		64/83	64/83	67/83
Heat emission					
% of installed power	max		5	5	5
Shipping data					
Weight	net, kg		2600	2800	2900
Dimensions in mm					
A Width			1496	1726	1956
B Depth			1363	1363	1363
C Height			2040	2040	2040
D			990	990	990
E			240	240	240
F			965	1080	1195
I			790	790	790
K			2075	2075	2075
1 Electrical connection 2 Cold water 3 Hot water 4 Cold soft water 5 Steam connection 6 Drain 7 Liquid supply connection 8 Soap box 9 Compressed air 10 Loading/unloading door 11 Control panel 12 Vent connection					

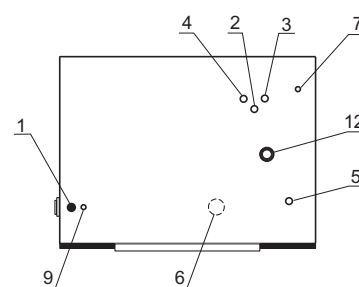

Top view

* Other voltages available, see installation manual.

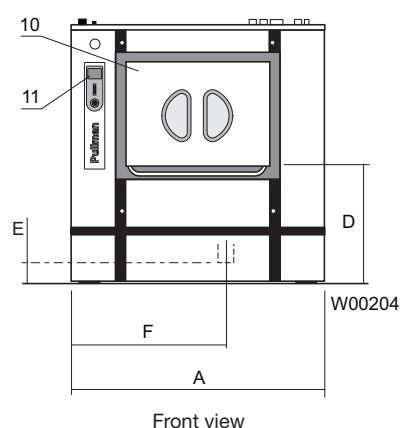

Front view

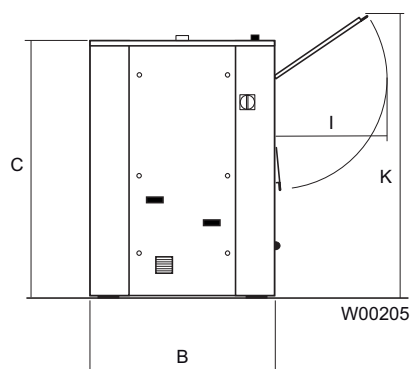

Left side view

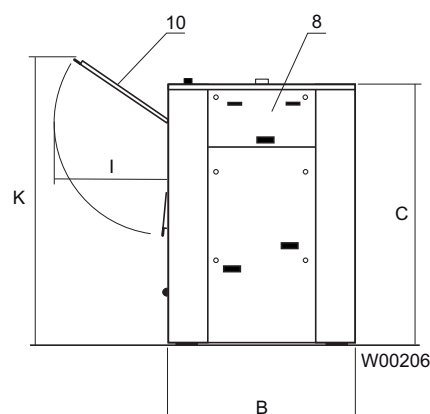

Right side view

Thinking of you
Electrolux

www.electrolux.com/laundrysystems

Share more of our thinking at www.electrolux.com

Art. No. 438903361/01 08.22
 We reserve the right to alter specifications without notice.